



# ECO

## mod. ES100



### Basic characteristics

- ✓ Stylish design and compact dimensions
- ✓ Rapid installation on directable supports
- ✓ A transmitter unit and a receiver unit
- ✓ Power supply in direct current 12V or 24V without commutation
- ✓ Operating distance up to 100 m
- ✓ Ral 1013 pearl white
- ✓ (Different Ral colours available on request)

### Characteristics of the product

- ✓ EN 54/12 and VdS Standard
- ✓ CE according to CPD
- ✓ EMC tested at 30 V/m
- ✓ RoHS compatible
- ✓ Minimal power absorption under all working conditions
- ✓ Interface incorporated to signal alarm or fault
- ✓ Maintenance request
- ✓ Can signal alarm after a fault
- ✓ Adjustable with cover closed
- ✓ Constant sensitivity according to environmental conditions
- ✓ Angular misalignment: 1 degree max
- ✓ Fine calibration threshold adjustment
- ✓ Self-compensating threshold
- ✓ Vertical installation possible
- ✓ Transmitter unit, Receiver unit, diaphragms kit, swivel supports and manual in single compact packaging

 is the line smoke detector made up of a transmitter unit and a receiver unit, that has been specially designed to solve problems related to installation in civil buildings such as:

- buildings of particular artistic value
- museums
- conference halls
- places of worship
- rooms with strong air currents
- false ceilings
- laboratories

 combines the performance and guarantee of quality of new technology using microprocessors for fire detection, fully compliant with European standard EN54-12.

 is the new line detector that provides swift and reliable detection of fires in various kinds of environment, assuring maximum safety under all conditions.

 is already built to meet the demands of the future, meeting product standards as well as being environmentally friendly.



## BASIC CHARACTERISTICS

# ES100

**The current absorption is intended for the total of the two eco units (transmitter and receiver)**

Power supply of 12V DC to 24V DC without commutation required.

Power supply tension	12V $\pm$ 20 %		24V $\pm$ 20 %	
Capacity adjusted by switch S1	TX LO mA	TX HI mA	TX LO mA	TX HI mA
In normal working	45	87	26	47
In alarm	70	105	38	60

Contact capacity	Alarm relay 1A@30V;	Fault OptoRelay 170mA@30V
Maximun cable lenght @24V	1000m/ cross section 0,5mm <sup>2</sup> ;	2000m/section 1mm <sup>2</sup>
Maximun cable lenght @12V	500m/section 1mm <sup>2</sup>	
Maximun cover	(750m <sup>2</sup> ) 15m x 50m at LO;	(1500m <sup>2</sup> ) 15m x 100m at HI
Width of cover	15m (EN54/14)	
Temperature of working	-20°C ÷ +60°C	
Storage temperature	-25°C ÷ +70°C	
Minimun operating distance	2m	
Maximun operating distance	100m	
Relative humidity	95%	
Protection rating	IP44	

## WIRING DIAGRAM

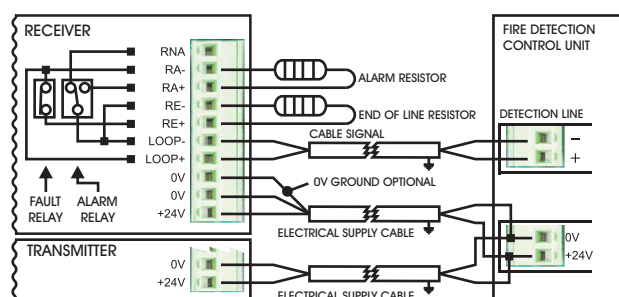

## SIZE (mm)

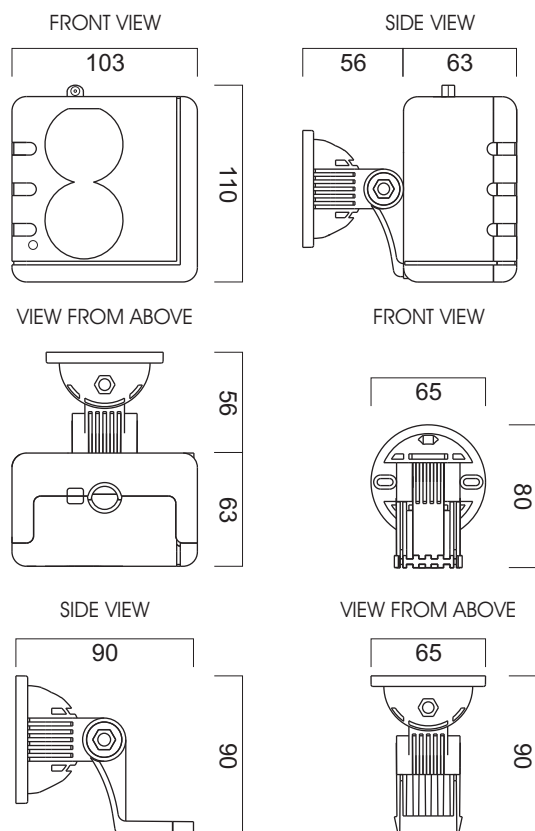

## CERTIFICATIONS



N° G205128



0786-CPD-20214

**EN54/12**

## WEIGHT (g)

Transmitter Unit 360  
Receiver Unit 360  
SEM bracket 70

## MATERIALS

Cover Polycarbonate  
Bottom ABS  
Bracket ABS

## EXAMPLES OF USE

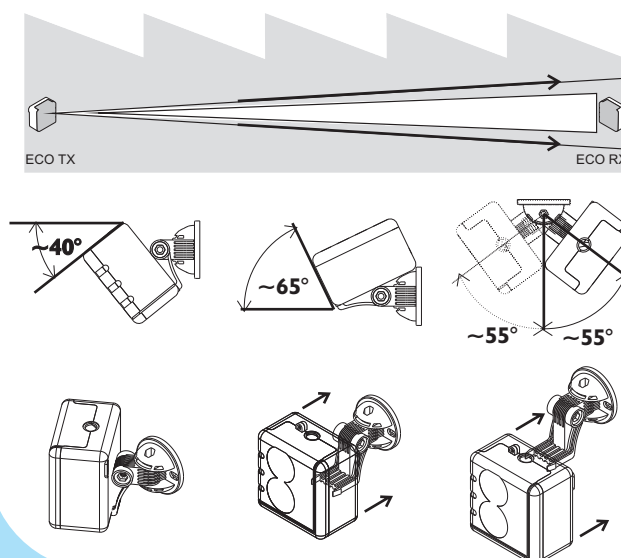

+39 045 8347777 +39 0458347778  
www.setronicverona.com