



# ECO

# MOD. ES80



### *Basic characteristics*

- ✓ Stylish design and compact dimensions
- ✓ Rapid installation
- ✓ Transmitter-Receiver unit and reflector unit
- ✓ New design articulated support
- ✓ 12V or 24 V DC power supply without switching
- ✓ Operating distance up to 80 m
- ✓ RAL 1013 pearl white (different Ral colour on request)

### *Characteristics of the product*

- ✓ EN 54/12 and VdS Standard
- ✓ **CE** according to CPD
- ✓ EMC tested at 30 V/m
- ✓ RoHS compatible
- ✓ Minimal power absorption under all working conditions
- ✓ Interface incorporated to signal alarm or fault
- ✓ Maintenance request
- ✓ Can signal alarm after a fault
- ✓ Adjustable with cover closed
- ✓ Constant sensitivity according to environmental conditions
- ✓ Angular misalignment: 5 degrees max on reflector unit
- ✓ Response at 12 dB
- ✓ Fine calibration threshold adjustment
- ✓ Self-compensating threshold
- ✓ Vertical installation possible
- ✓ Wall fastening with or without supports
- ✓ The TRX unit, reflector unit, swivel supports, diaphragms kit and manual in single compact packaging

 is the line smoke detector system specially designed to solve installation problems in civil buildings such as:

- buildings of particular artistic value
- museums
- conference halls
- places of worship
- structures with complex or frescoed ceilings
- libraries
- art galleries
- schools and colleges
- theatres

 combines the performance and guarantee of quality of new technology using microprocessors for fire detection, fully compliant with European standard EN54-12.

 is the new line detector that provides swift and reliable detection of fires in various kinds of environment, assuring maximum safety under all conditions.

 is already built to meet the demands of the future, meeting product standards as well as being environmentally friendly.



## TECHNICAL CHARACTERISTICS

# ES80

Electrical supply of 12V DC to 24V DC without commutation required.

Power supply tension	12V ± 20 %		24V ± 20 %	
	TX LO mA	TX HI mA	TX LO mA	TX HI mA
In normal working	35	79	19	39
In alarm	62	95	32	52

Contact capacity	Alarm relay 1A@30V;	Fault OptoRelay 170mA@30V
Maximum cable length @24V	1000m/ cross section 0,5mm <sup>2</sup> ;	2000m/section 1mm <sup>2</sup>
Maximum cable length @12V	500m/section 1mm <sup>2</sup>	
Maximum cover	(1200m <sup>2</sup> ) 15m x 80m at HI	
Width of cover	15m (EN54/14)	
Temperature of working	-20°C ÷ +60°C	
Storage temperature	-25°C ÷ +70°C	
Minimum operating distance	10 m	
Maximum operating distance	80 m	
Relative humidity	95%	
Protection rating	IP44	

## WIRING DIAGRAM

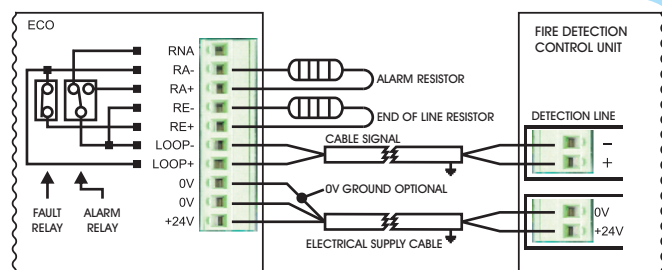

## SIZE (mm)

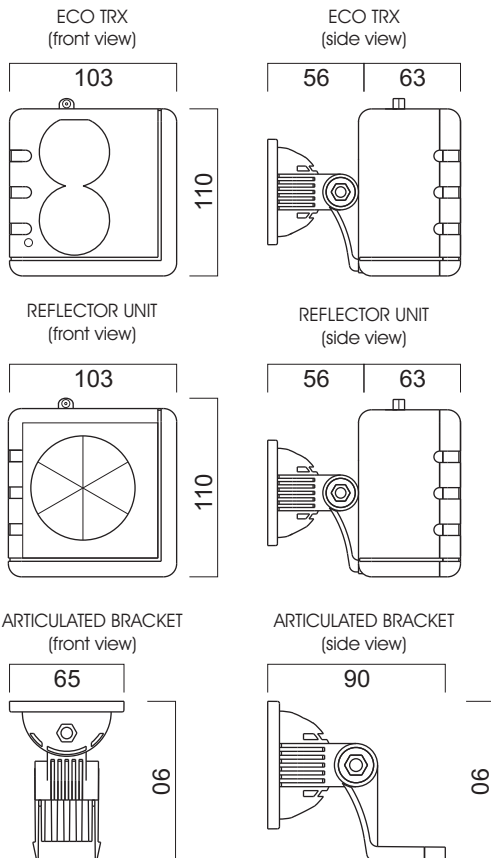

## CERTIFICATIONS



N° G205128



0786-CPD-20214

**EN54/12**

## WEIGHT (g)

TRX unit 360  
Articulated bracket SEM 70  
Reflector unit 450 (with bracket)

## MATERIALS

Cover Polycarbonate  
Bottom ABS  
Articulated bracket ABS

## EXAMPLES OF USE

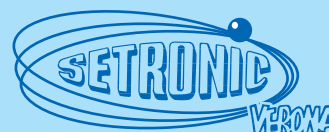
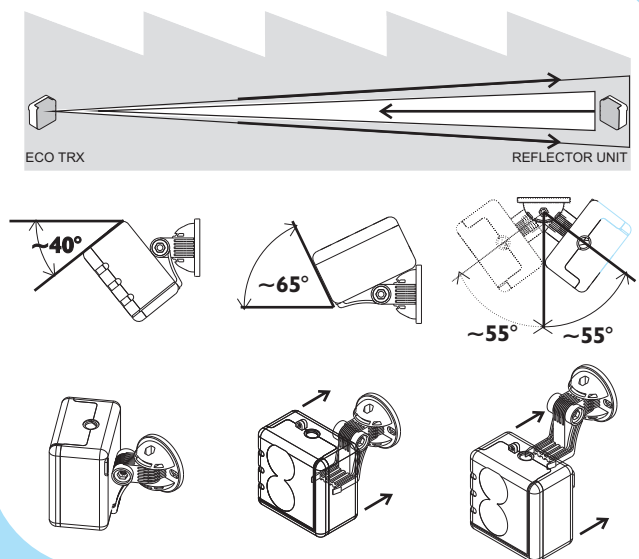

+39 045 8347777 +39 0458347778  
www.setronicverona.com